



©1994 Outboard Marine Corporation.
All rights reserved.

34240B



DD

10/94



INSTALLATION INSTRUCTIONS

Cylinder Head and Muffler Kit

437826

SAFETY

These installation instructions contain information that can help prevent personal injury and damage to equipment. Understand the following symbols before proceeding:

 Safety Warning	Alerts you to the possibility of danger and identifies information that will help prevent injuries.
 Note	Identifies information that will help prevent damage to machinery.
 Important	Appears next to information that controls correct assembly and operation of the product.

TO THE OWNER

The assembly procedures outlined in this sheet should be performed by a skilled technician. If you have questions, see your DEALER. Save these instructions in your owner's kit. This sheet contains information important to the future use and maintenance of your engine.

TO THE INSTALLER

Give this sheet to the owner. Advise the owner of any special operation or maintenance information contained in the instructions.

PREFACE

Use these instructions and an **OMC TurboJet™** service manual, to install these parts on a 115JEER or a 115JEE0 **TurboJet™**.

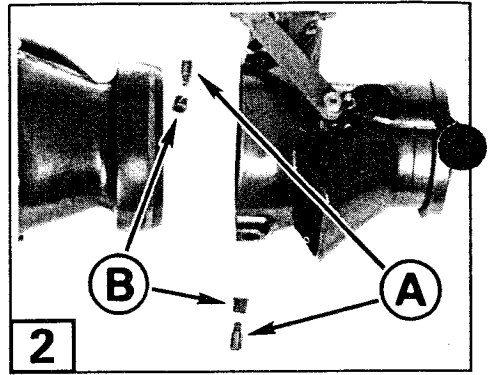
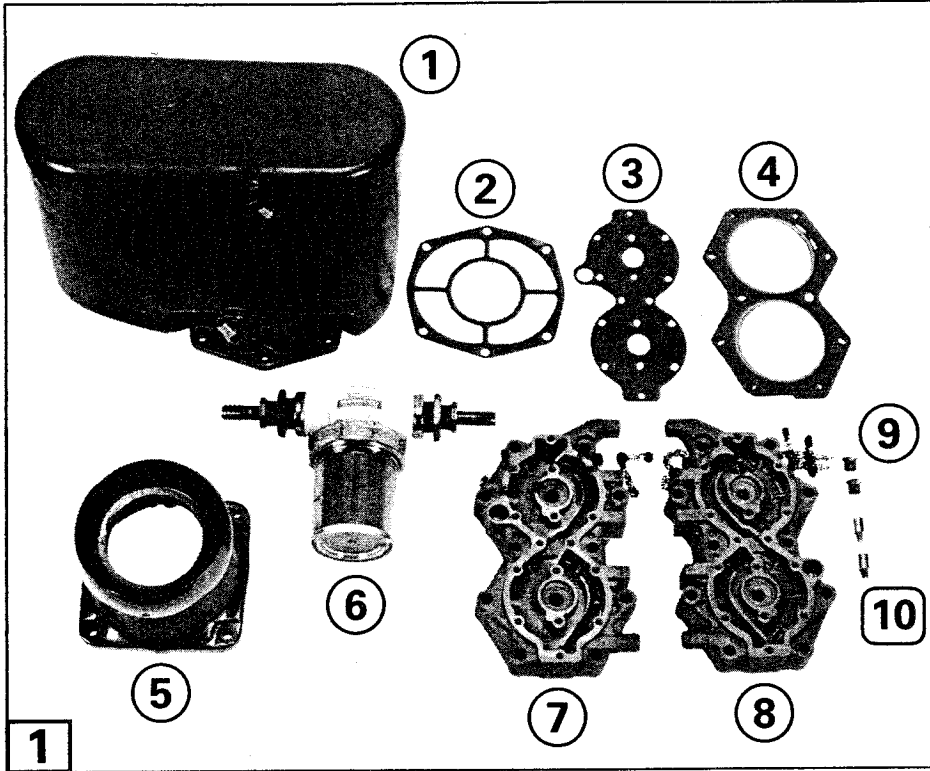

35076

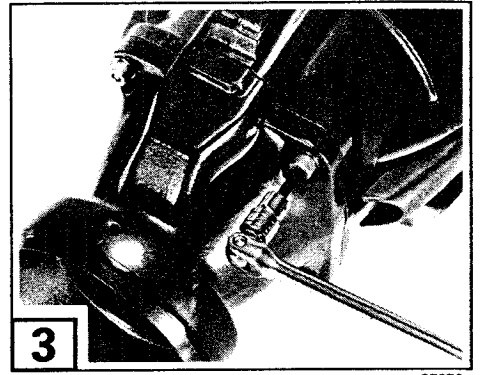

35370

39444

1 Contents of kit:

Ref.	P/N	Name of Part	Qty.
①	437799	Muffler	1
②	339858	Muffler to Adaptor Gasket.	1
③	318335	Cylinder Head Cover Gasket	2
④	318358	Cylinder Head Gasket	2
⑤	342324	Impeller Nozzle	1
⑥	437598	Sea Water Strainer Kit	1
⑦	342321	Port Cylinder Head	1
⑧	342322	Starboard Cylinder Head.	1
⑨	340365	Bushing	2
⑩	340366	Pump Nozzle Screw	2

Following procedures in the **OMC TurboJet™** service manual, remove the muffler and both port and starboard cylinder heads. Clean all gasket surfaces.

1 Transfer cylinder head covers, temperature switches, spark plugs, ignition coils, and wires from the original cylinder heads to the cylinder heads ⑦ and ⑧ provided in this kit.

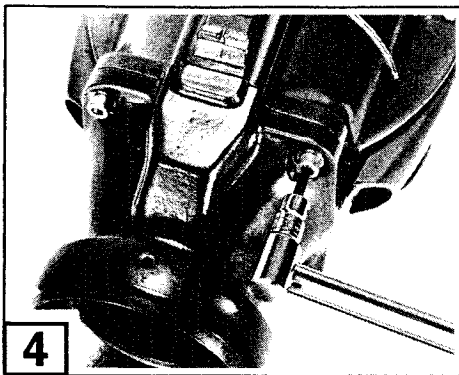

35371

Install cylinder heads and muffler ① following procedures described in the service manual.

2 Remove steering and shift cables from the steering nozzle. Remove screws **A** retaining the steering nozzle to the impeller nozzle. Remove the nozzle. Discard screws and bushings **B**.

3 Remove the screws and washers retaining impeller nozzle to impeller housing. Remove the nozzle and discard it. Save the washers and screws.

4 Apply **OMC Nut Lock** to threads of impeller nozzle to impeller housing screws. Secure the new impeller nozzle to impeller housing with screws and washers. Torque to 80-90 in. lbs. (9-10 N.m).

2 Install new bushings **9** in steering nozzle. Prime the threads of the new screws **10** with **OMC Locquic Primer**. Apply **OMC Ultra Lock** to the threads of the screws and tighten to 162 in. lbs. (18 N·m). Do not allow the **OMC Ultra Lock** to touch the bushings or the bushing bores.

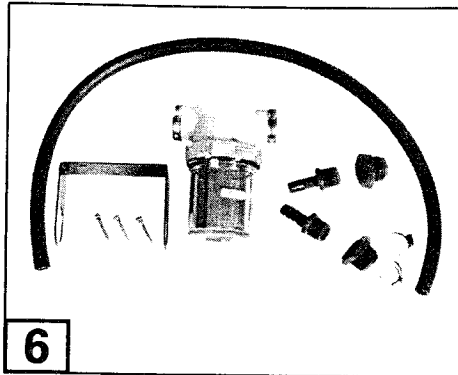
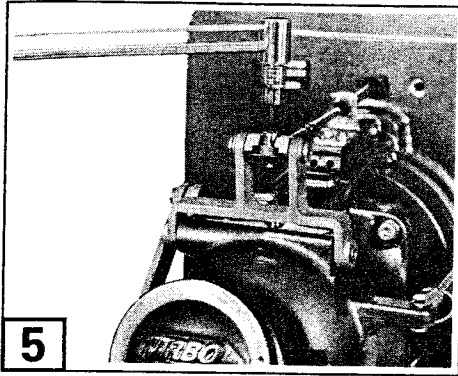

5 Install the cable end into its retainer on top of the gate lever. Prime the threads of the shoulder screw with **OMC Locquic Primer**. Apply **OMC Ultra Lock** to the shoulder screw. Insert the screw and tighten it to 162 in. lbs. (18 N·m).

⚠ **Make sure all fasteners are tight. Failure to securely tighten shift components could result in loss of control and injury.**

6 Install the sea water strainer kit following the instructions supplied with the kit.

Test your work! Verify all steering and shifting functions before returning the boat to the owner.

